

RURAL PHARMACY  
GROUND FLOOR PLAN  
(281.61 SQ. M.)

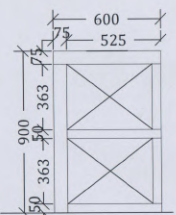

WORKING TABLE DETAIL (WOODEN DETAIL)  
DETAIL AT A  
SCALE: 1:20

- STAFF CIRCULATION
- MATERIALS AND GOODS CIRCULATION
- ▨ 94 MM CEMENT BOARD
- ▨ 230 MM BRICK WALL
- ▨ DRY WALL UP TO 1800MM HT AND GLASS ABOVE

|  |  |  |   |                                      |   |   |                                 |             |
|--|--|--|---|--------------------------------------|---|---|---------------------------------|-------------|
| Government of Nepal<br>Ministry of Urban Development<br>Department of Urban Development & Building Construction<br>HEALTH BUILDING SECTION, BABARMAHAL | Project<br><b>AYURVED RURAL PHARMACY</b> | DUDBC TEAM   |   |                                      | DEPARTMENT OF AYURVED AND ALTERNATE MEDICINE TEAM |   | Scale: 1:100<br>Date: JUNE 2019 | <b>A/01</b> |
|  | Sheet Title<br><b>GROUND FLOOR PLAN</b>  | Designed By:<br>Ar. Smriti Kayastha<br>Ar. Smriti Upadhyaya<br>Ar. Jagdish Chandra Jaiswal | Checked By:<br>Ar. Smriti Upadhyaya<br>Ar. Smriti Kayastha<br>Ar. Jagdish Chandra Jaiswal | Recommended By:<br>S.D.E. Himal K... | Consulted To:                                     | Approved By:<br>DG. Dr. Vasudev Upadhyaya |                                 |             |